



- Installation Manual -

289 270 XXX, 289 290 XXX (SAFETY21 steel)
289 261 XXX, 289 265 XXX (D1 Rollcage Chromoly)

Nissan GT-R R35 Rollcage

Disclaimer

*For off-road use only. Please check regulations for usage in sanctioned motorsports.

*CUSCO roll cages are engineered to enhance safety and promote chassis rigidity for motorsports purposes.

*Carrosser & CUSCO is not liable for any injury or death caused by the usage of this product.

*Carrosser & CUSCO is not liable for voided vehicle manufacturer warranty. Please acknowledge and confirm warranty terms before purchase.



CUSCO USA Inc.
16631 Gemini Lane
Huntington Beach, CA 92647
Tel: (714) 907 - 0033
Fax: (714) 369 - 8142
info@cuscouainc.com
www.cuscouainc.com

Thank you for purchasing CUSCO products. Please make certain that this instruction manual and the vehicle's factory service manual is fully read and acknowledged prior to installation. When transferring usage of the product, please make sure the instruction manual is given to the new owner with the product, or to anyone operating the vehicle. When this product or the vehicle equipped with this product is given/let borrow to others, please hand this manual to the person who receive the product or vehicle.



Wear protective eyewear and gloves.



Please read this first

Attention

A potential possibility of malfunction and (or) breakage can result to the product and (or) to the vehicle if this indication is ignored, if wrongful usage and (or) operation is performed.

- This instruction manual includes the usage and installation. Read this manual thoroughly before operating. Please keep this instruction in the vehicle at all times.
- This product is for off-road or competition use only. By reading this warning the customer acknowledges that Cusco products are not permitted for use on public highways.
- This product includes all components listed in this instruction manual. If there are any missing or damaged parts, please contact an authorized CUSCO retailer.
- Always disconnect the battery before beginning any type of work on the vehicle.
- CUSCO cannot be responsible for any loss or damage to the product or the vehicle, when used in combination with other product(s) and (or) unauthorized tamperment to this product.
- CUSCO cannot be responsible for any injury or damage caused to the individual or third party as well as malfunction of the vehicle, products and (or) accessories.
- This product and accessories can be changed without prior notice due to production and manufacturing reasons.
- CUSCO cannot be responsible for any factory OEM parts lost during temporary removal process when performing installation.
- Some components such as car audio and clock can lose memory when the battery is disconnected while installing. After completion of the installation process, recover the setting referring to each instruction manual. CUSCO cannot be responsible for lost settings.
- Perform periodical inspection. The durability of this product can vary depending the surrounding conditions and usage.
- CUSCO cannot be responsible for any voided factory warranty due to installation of this product.
- Acknowledge that the installation of CUSCO products will alter vehicle control characteristics. Operate vehicle with extreme caution after product installation.
- Always install products according to the automobile manufacturer factory service manual unless otherwise specified in this installation manual.

Danger

An immediate possibility of serious injury and (or) even death can be assumed to the individual and (or) to the third party if this indication is ignored and wrongful usage and (or) operation is performed.

- Any service to the car with removal of the parts should be performed by trained professionals at a properly equipped workshop.
- Resting, sleeping in the car, or working in the car or in the closed garage can cause carbon monoxide poisoning, which can be fatal. Must turn the engine off and keep the area well ventilated.
- Always place wheel chock to prevent the vehicle from moving.
- Be careful with wiring when making connections directly in relationship with driving equipment, such as engine, steering, brake, and air-bag.
- Always make sure that the wiring is done properly. Take extra caution when dealing with positive and negative polarity. Make sure that the wires are insulated and there are no loose wires. If any wiring is performed in error, it may cause a fire on this product and/or the vehicle. Please disconnect the battery terminal wires before beginning the installation process. In case if it is not possible to shut off the power supply, it is your own responsibility to protect yourself from any injury as well as avoid electric shock and/or short circuit which can cause damage to the product and/or the vehicle.
- Use and install Cusco products only as directed by the manufacturer. Do not modify product to fit unspecified application. Misuse of product may lead to serious injury or death.

Warning

An potential possibility of serious injury and (or) even death can be assumed to the individual and (or) to the third party if this indication is ignored and wrongful usage and (or) operation is performed.

- Exhaust manifold, radiator, and engine can be very hot. Please provide sufficient cool down time before starting any installs.
- Exhaust manifold, radiator, engine can be extremely hot while the vehicle is running immediately prior to vehicle usage. There is high possibility of injury when coming in contact with such components.
- Keep clear from infants, small children, and animals. Keep small parts away to avoid accidents. (prevent the parts from being swallowed/inhaled)
- Exhaust pipe can be very hot. Wear proper protective clothing when working in or around this area.
- Avoid installing any product in areas that can interfere with vision of the front windshield, driving equipments, and/ or air-bag system and other safety features..
- Take caution when installing this product near electric wires, water hoses, and air hoses. and avoid inflicting and damages to them. Damaging the electric wires, water hoses, and air hoses can cause shot circuit and/or critical engine damage.

Caution

An potential possibility of serious injury and (or) even death can be assumed to the individual and (or) to the third party if this indication is ignored and wrongful usage and (or) operation is performed.

- Dropping and/or applying the excessive force to this product before or during installation can cause damage, resulting in malfunction of the product.
- This product is designed to be used in 12V power vehicles only. Do not install this product in different voltage supplied vehicle.
- Make sure to insulate the unused connector and wirings to avoid short circuiting.
- Always use the supplied hardware.
- Installation of components on the passenger side or center section can interfere with safety standards. Please check within local regulations before installing.
- Use a soft cloth to clean the product gently. Using cleaners or abrasive agents can damage the product.

Notes

Warning

- Installation by non-professionals and unauthorized shops voids product warranty.
- Always focus on driving first, and never on the gauge displays. This may cause vehicle accidents and can even result in death.
- Perform product setting adjustment and other operation when the vehicle is parked at safe place.
- Do not disassemble or apply any modifications to this product. Such alterations can cause vehicle accidents or product damage. This also voids the product warranty.
- If any problem is found (wet/odor/smoke/erratic movement etc.), stop using the product IMMEDIATELY and contact your local retailer. Prolonged usage with such symptom can lead to accident or vehicle damage.
- CUSCO cannot be responsible for any damages while using this product, or any damages caused by this product usage.

- [Part Number]** 289 270 XXX, 289 290 XXX (SAFETY21 steel)
289 261 XXX, 289 265 XXX (D1 Rollcage Chromoly)
- [Application]** NISSAN GT-R (R35)
- [Product]** GT-R Rollcage
- [Description]** SAFETY21 & D1 Rollcage [dashboard escape & through]

[Contents]

	COMPONENT	QTY	NOTES
1	Main Hoop (Main Arch)	1	
2	Right Rear Bar (C-Pillar)	1	
3	Left Rear Bar (C-Pillar)	1	
4	Right Front Bar (A-Pillar)	1	* 1
5	Left Front Bar (A-Pillar)	1	* 1
6	Front Roof Bar (Halo Bar)	1	* 1
7	Diagonal Bar	1	* 2
8	Rear Bar (C-pillar Horizontal)	1	* 2
9	Base Plate	2	A-Pillar Front Underplates * 1 . * 5
10	Base Plate	2	B-Pillar Main Hoop Underplates *
11	Base Plate	2	C-Pillar Rear Underplates * 5
12	Bolt M 1 0 × 4 5	1 0	For Joint Assembly * 3
13	Washer M 1 0	1 0	For Joint Assembly * 3
14	Nut M 1 0	1 0	For Joint Assembly * 3
15	Bolt M 8 × 2 5	1 8	For Chassis Attachment * 4
16	Washer M 8	1 8	For Chassis Attachment * 4
17	Washer M 8	1 8	For Chassis Attachment * 4
18	Spring Washer M 8	1 8	For Chassis Attachment * 4
19	Nut M 8	1 8	For Chassis Attachment * 4

- *1 Not included in 4 and 5 point. -Content list is referenced for 8 point rollcage.
- *2 Choice between diagonal bar or rear bar. -Numbers 1~5 will vary for alternative rollcage points.
- *3 2 qty for 4 point, 4 qty for 5 point, 6 qty for 6 point, 8 qty for 8 point.
- *4 12 qty for 4 and 5 point.
- *5 Holes that are not used, see Fig. A

INITIAL INSTALL STEPS

- 1.) Assemble roll cage outside of vehicle and confirm the correct position of each piece. For roll cages 6 point and higher, make sure that the tabs designated to the A and C pillars are facing the correct position. Stickers indicate if the bars are right or left side.
- 2.) Remove front and rear seats to make installation an ease.
- 3.) Peel back carpeting and remove sound deadening material (undercoat) for the chassis point areas to ensure a direct contact with roll cage base and chassis.
- 4.) Install any roll bar padding prior to placement of roll cage inside the vehicle.
- 5.) Place roll cage inside vehicle and assemble. (Temporarily mock up main hoop, A-pillar, and C-pillar bars)
- 6.) Confirm and inspect dashboard, doors, glove box, and trim pieces to see if they require any modifications. (Varies on vehicle application)

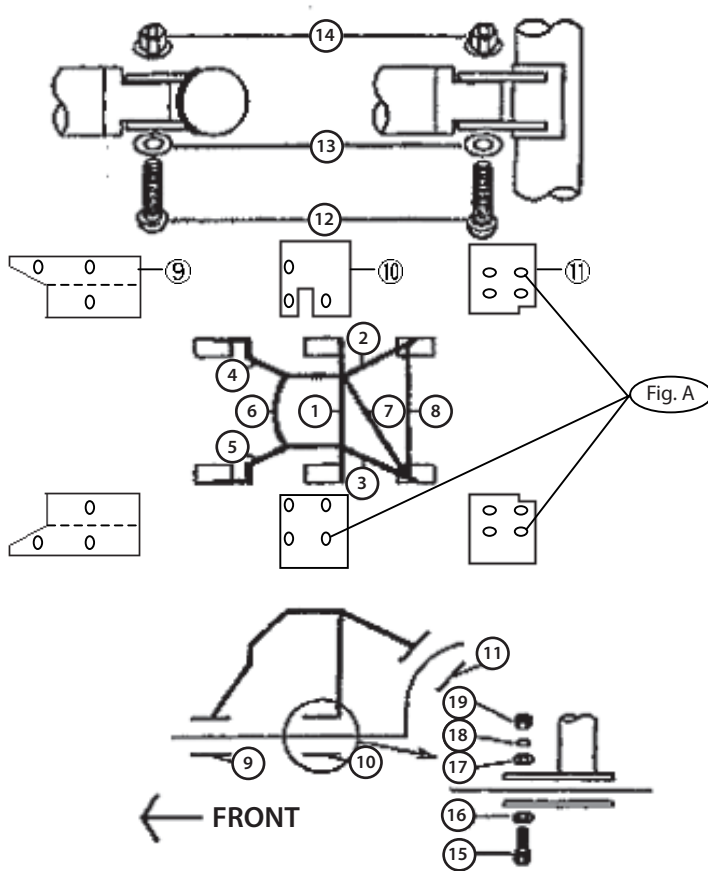

REAR & SIDE TRIM MODIFICATION

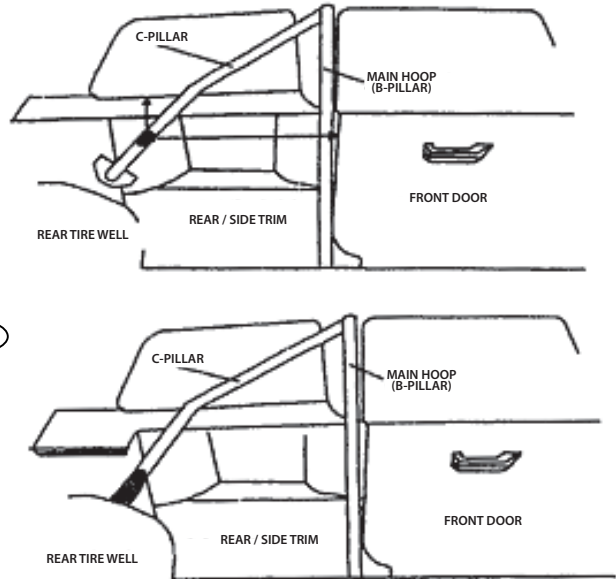

Areas marked in black will required to be drilled or trimmed.

REAR / SIDE / TRIM MODIFICATION STEPS

1. Place roll cage inside vehicle and assemble.
(Temporarily mock up A-pillar beams for 6 point and up)
2. Measure and indicate where rear piping (C-pillar) will be positioned and where it will pass through.
(Additionally, confirm the angle of the C-pillarbar)
3. Drill a small diameter hole to the areas indicated in step 2.
4. Confirm that the angle of the C-pillar bar is tolerable to pass through the trim piece by place testing a slimmer diameter bar to the holes drilled in step 3.
5. Widen the hole starting from the center if the place test bar does not indicate any misalignment according to the trim piece.
(Gradually widen the hole and keep in mind that a perfect circle is not exactly necessary. Widen the hole further if roll cage pads are being used.)
6. If the roll cage bar conflicts with the trim piece in reference to the tolerance, continue widening the hole gradually.



A-PILLAR FRONT CAGE INSTALLATION

- Remove undercoat / sound deadening material
- Begin drilling only after the bar position and clearance has been confirmed relative to the door and dashboard.
- Install roll cage padding first before installing the actual roll cage.

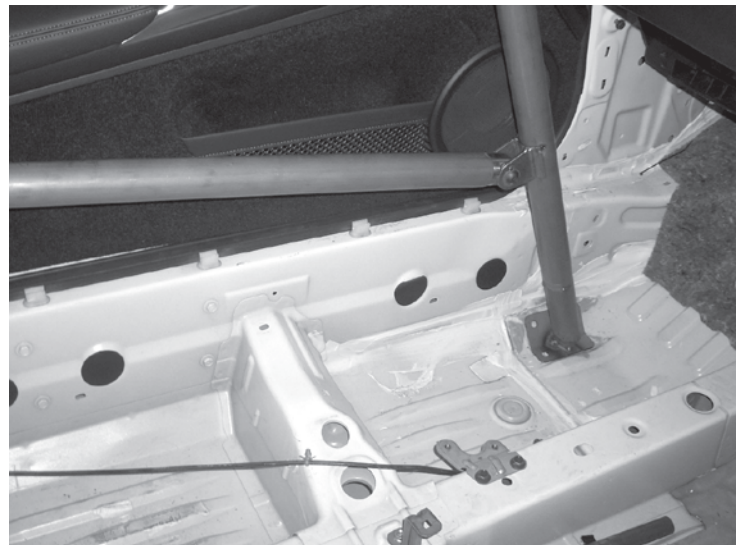
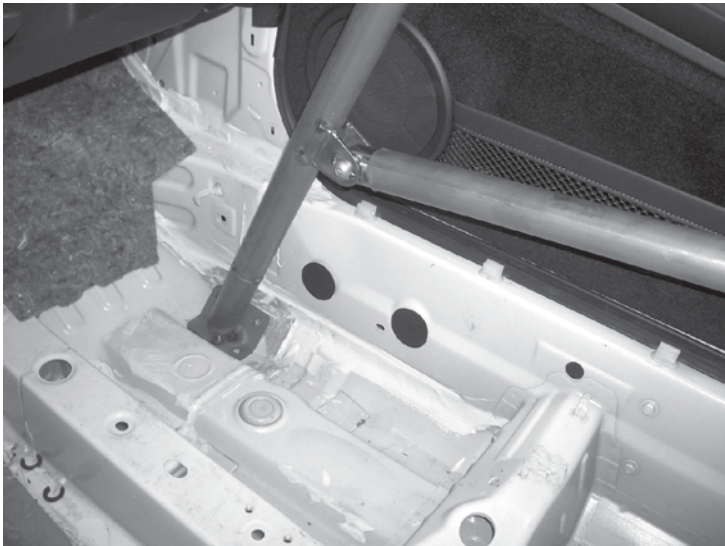

BASE PLATE INSTALL / FINAL STEPS

1. Confirm that the roll cage chassis plates are making contact with the desired areas of the chassis body and the entire position of the roll cage assembly is correct.
2. Mark the center of each hole where the roll cage base plates will be bolted. Start drilling with a smaller drill bit and once finished, confirm if the holes are aligned. (Use caution when drilling near fuel system related components such as fuel lines and tanks.)
3. Drill holes to desired size and pass the bolt through the roll cage plates from inside the chassis to out.
4. Secure base plates underneath the car, making sure that the position and designation for each plate is correct. (refer to diagram)The base plates are designed to contour to the specific surfaces of the underside of the vehicle.
5. Secure nuts to the bolts and torque down the base plates.
6. After each of the base plates are torqued down, inspect trim pieces, interior accessories, and any other component that might obstruct while driving. Check underneath vehicle for any fluid leaks.
7. Tighten all bolts for pillar bars.
8. Secure roll cage pads if applicable.
9. Reinstall front and rear seats and make necessary modifications if need be.
10. Reinspect torque for all bolts after driving the vehicle for 5~10 miles.



Main hoop right mounting area

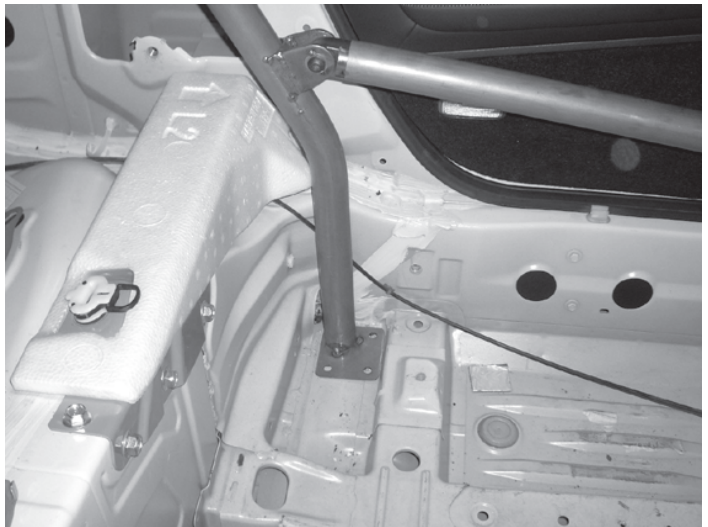

Main hoop left mounting area

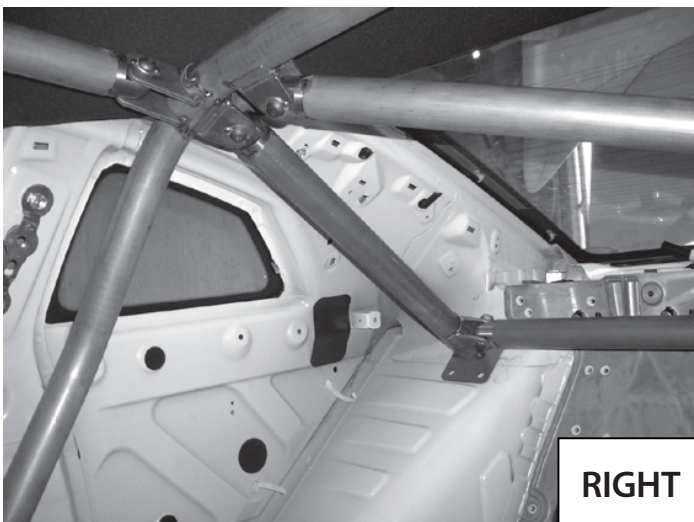

RIGHT



LEFT